

SPOT V50-STM



SPOT LEDS WITH FLY-BOP DEVICE

Applications:

- Electrical cabinet lighting
- Machine lighting
- Industrial lighting

Pros:

- **FLY-BOP** device (Rapid progressive lighting up) & (Slow progressive extinguishment)
- Adjustable power level
- Overheating protection
- Optimized feed & consumption
- Industrial grade led
- Operating temperature at +70°C
- IP69K Front panel
- Power supply: 10 to 30V

Description

The product V50-STM is a spotlight with the following characteristics:

- Adjustable power level
- Gradual on and off
- Debounce function on the input control
- Overheating protection

Assembly / Installation

The V50-STM product is fastened through a wall with a 55 mm diameter hole. The silicone gasket is placed between the housing and the wall to seal. The nut behind the wall allows the unit to be attached with hand tightening.

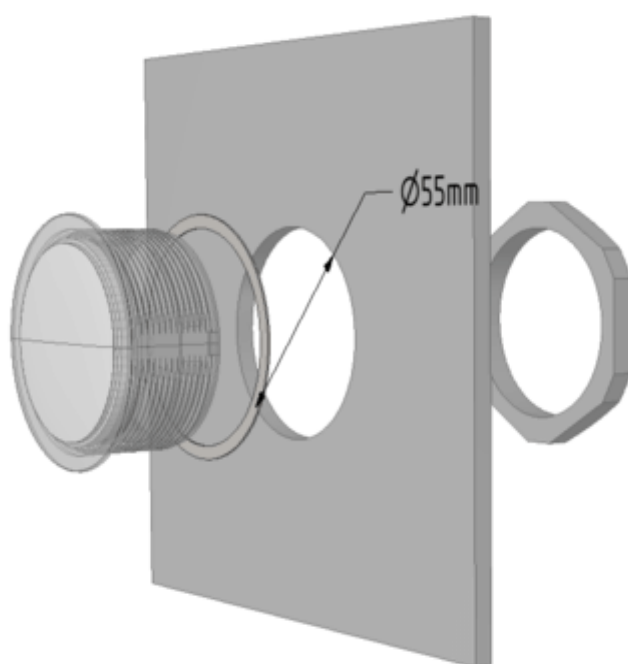

Operation

The product must be powered on. Input E1 is driven by a voltage pulse. The pulse width defines the following functions:

- Pulse less than 50 ms not taken into account (debounce filtering)
- Pulse between 50ms and 1 second: full power on (if the spot is off) or off (if the spot is on).
- Pulse greater than 1 second: brightness adjustment according to the pulse duration (from maximum brightness to minimum brightness). The setting is stopped when the minimum brightness is reached.

If the ambient temperature is above 70°C, an internal protection protects the reliability of the spot by adjusting the light output. Reaching a critical temperature (around 100°C ambient) the spot is completely deactivated.

The automatic adjustment of the light output of the spot according to the ambient temperature is very slow and therefore not detectable by the human eye.

Technical specifications

| | |
|---------------------------------|---|
| Supply voltage | 10 - 30VDC |
| Nominal voltage | 24 VDC |
| Temperature | -25°C to +70°C |
| IP Front panel | IP69K (+ silicone seal/nut) |
| IP Rear panel | IP40 Terminal block |
| Connection | Terminal block: wire 0.2-1.5mm ² |
| Maximum current in the contacts | 180 mA |
| Brightness | 220 lumens max |
| Light density at 30 cm | 940 lux |
| Housing material | PP-ULV0 |
| Indicator life time | 6600 hours |
| Input E1: impedance | 100 kOhms |
| Input E1: low level | 0-5 VDC |
| Input E1: high level | 10 - 30 VDC |

Connectors

Item code

Terminal block version

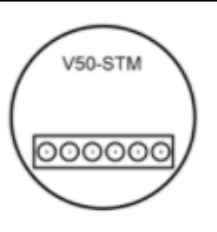
| Pin number | Function |  |
|------------|---------------|---|
| 1 | 10VDC - 30VDC | |
| 2 | 0 VDC | |
| 3 | E1 PNP | |

V50-STM

W : White housing
Y : Yellow housing
B : Black housing

Dimensions

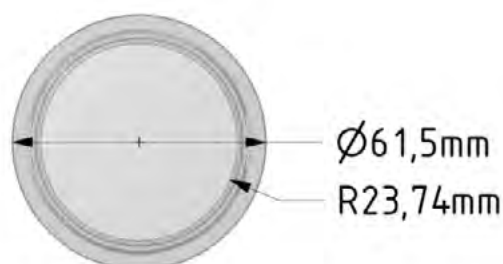
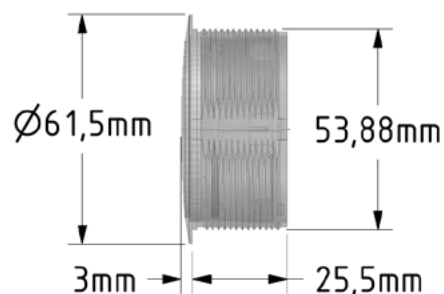

OUR ADDRESSES

COMITRONIC-BTI

**14 Rue Pierre Paul de Riquet
33610 Canéjan
France**



Tel : +33 5 64 10 04 52

Email : vente@comitronic-bti.fr

www.comitronic-bti.com - www.comitronic-bti.com - www.comitronic-bti.de

COMITRONIC-BTI GMBH

**VICTORIA BOULEVARD A106
77836 RHEINMÜNSTER
DEUTSCHLAND**



Ph: +49 7229 6991611

Email: kontakt@comitronic-bti.de

OUR GOAL : INNOVATION